

ACCSH200

## Single AV Wall Shelf with Glass for AV Components

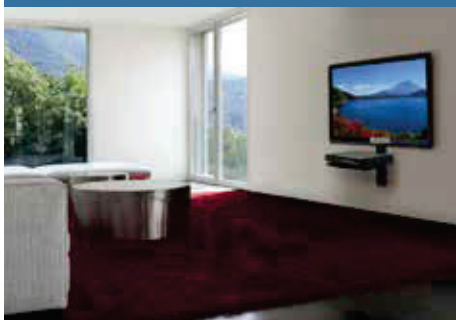

People gravitate toward flat panel displays for their aesthetics but once mounted the question of where to place the audio visual components becomes troubling. This AV Wall Shelf provides an elegant solution. The modern, sleek glass shelving blends in with the décor of a room enhancing the image so carefully cultivated by the consumer. Its ability to organize and center AV components directly above or below the display transforms any room by creating a trendy ambiance.



Max load: 13.6kg (30lb)

### FEATURES

- Strong, tempered glass shelf can be vertically adjusted to accommodate AV components of any height
- Cable management system helps keep cables concealed and organized
- Supports up to 13.6kg (30lbs)
- Bubble level makes for a quick and easy installation

#### ■ ADJUSTABLE HEIGHT

Easily adjust the height of the component shelf after installation without the use of tools

#### ■ BUBBLE LEVEL

For a quick and easy installation without the use of extra tools



#### ■ TEMPERED GLASS SHELF

For up to 13.6kg of support with a sleek, modern look

#### ■ CABLE MANAGEMENT

Keeps component cables concealed and organized



Side View

RoHS

CLICK: [www.peerless-av.com](http://www.peerless-av.com)

CALL: 800.865.2112

FAX: 800.359.6500

peerless-AV™

# Model Numbers

WARRANTY: Limited 5-year

ACCSH200 Single AV Wall Shelf with Glass for AV Components

# Product Specifications

	DIMENSIONS (W x H x D)	PRODUCT WEIGHT	LOAD CAPACITY	FINISH	AVAILABLE COLORS
ACCSH200	15.6" x 13.41" x 13.76" (396 x 341 x 350mm)	2kg (4.5lb)	13.6kg (30lb)	Powder coat	Gloss Black

# Package Specifications

	PACKAGE SIZE (W x H x D)	PACKAGE SHIP WEIGHT	PACKAGE UPC CODE	PACKAGE CONTENTS	UNITS IN PACKAGE
ACCSH200	13.25" x 2.625" x 17.125" (337 x 67 x 435mm)	2.56kg (5.65lb)	735029277385	AV Wall Shelf with Glass, Instructions, Installation hardware	1

All dimensions = inch (mm)

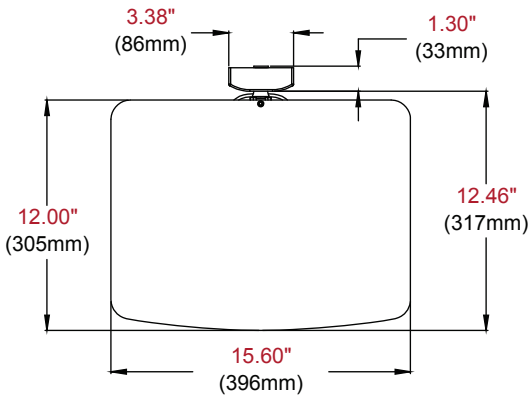

TOP VIEW

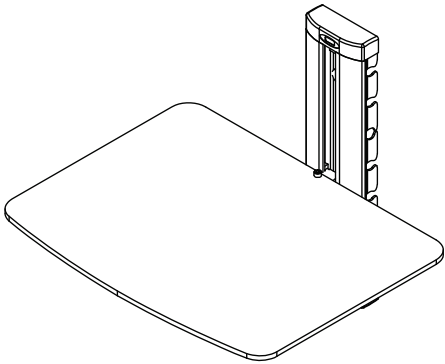

ISOMETRIC VIEW

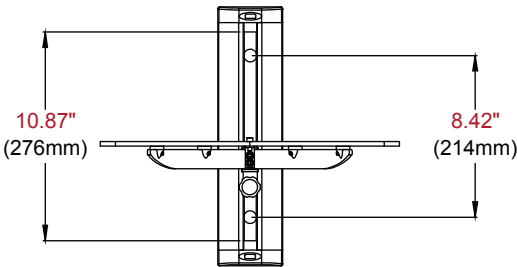

FRONT VIEW

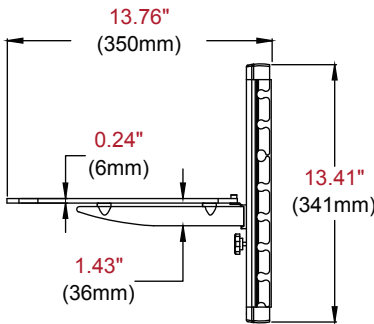

SIDE VIEW

# ARCHITECTS SPECIFICATIONS

The Peerless-AV Single AV Wall Shelf with Glass shall be model ACCSH200.  
Assembly and installation shall be done according to instructions provided by the manufacturer.

Peerless Industries, Inc. ■ 2300 White Oak Circle ■ Aurora, IL 60502 ■ (800) 865-2112 ■ (630) 375-5100 ■ Fax: (800) 359-6500 ■ [www.peerless-av.com](http://www.peerless-av.com)

Visit [www.peerless-av.com](http://www.peerless-av.com) to see the complete line of AV solutions from Peerless-AV, including flat panel mounts, projector mounts, carts/stands, furniture, cables, screen cleaners and a full assortment of accessories.